

Keysight U8030 Series Triple-Output DC Power Supply

Higher power. Better reliability. Unrivalled performance.



Keysight Technologies, Inc. combined its years of knowledge and expertise to introduce the U8030 series - the only triple-output power supply in its class to offer output sequencing that can be setup and generated right from its front panel without any computer programming. This automation capability improves test efficiency by allowing you to preset output sequences for margin tests, burn-in tests and other general purpose tasks in an industrial setting. Other essential features include excellent load regulation and clean output noise. With these, you get a reliable triple-output power supply at an unbeatable performance.

Key features

- 375 W total power for three outputs
- Output sequencing capability
- Excellent load regulation (CV: $< 0.01\% + 2 \text{ mV}$; CC: $< 0.02\% + 2 \text{ mA}$) ensures stable output
- Provides clean output with $\leq 1 \text{ mVrms}$ (0.5 mVrms typical) noise
- Fast $< 50 \mu\text{s}$ transient response for stable testing
- Dual display shows both voltage and current reading
- Over-voltage and over-current protection

Front panel description

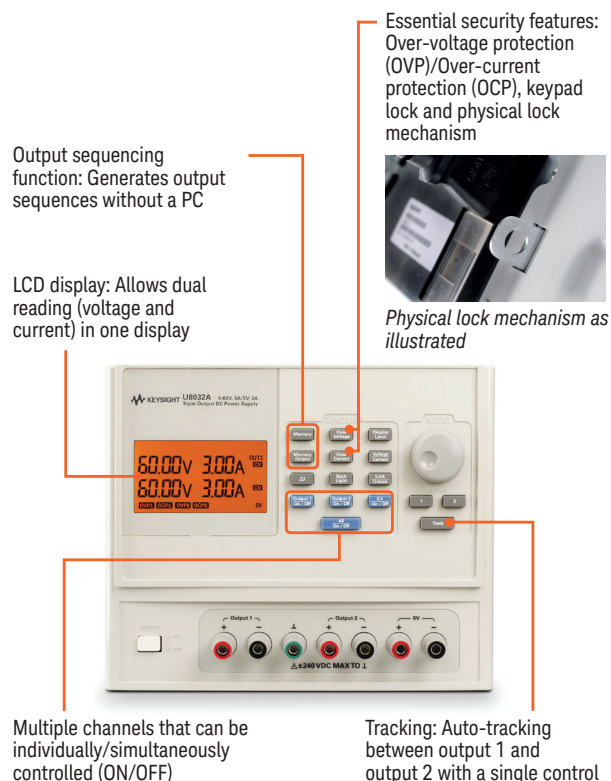

Power supplies come with:

Power cord, Quick Reference Guide, CD ROM (contains User Guide and Service Guide), Certificate of Calibration

Ordering information

Part	Description
U8031A	Triple-output DC power supply 30 V/6 A (2x) & 5 V/3 A; 375 W
U8031A-ABA	English language user guide, printed
U8031A-ACF	Japan – Japanese user guide, printed
U8031A-UK6	Commercial calibration with test result data
U8031A-1CM	Rackmount kit – mounts one with blank filler panel included
U8032A	Triple-output DC power supply 60 V/3 A (2x) & 5 V/3 A; 375 W
U8032A-ABA	English language user guide, printed
U8032A-ACF	Japan – Japanese user guide, printed
U8032A-UK6	Commercial calibration with test result data
U8032A-1CM	Rackmount kit – mounts one with blank filler panel included
E3600A-100	Test lead kit

Key specifications

	U8001A	U8002A	U8031A (New)	U8032A (New)
Number of outputs	1	1	3	3
DC outputs				
Voltage 1	30 V	30 V	30 V	60 V
Current 1	3 A	5 A	6 A	3 A
Voltage 2	–	–	30 V	60 V
Current 2	–	–	6 A	3 A
Voltage 3 (fixed)	–	–	5 V	5 V
Current 3	–	–	3 A	3 A
Power (max)	90 W	150 W	375 W	375 W
Programming accuracy	0.35% + 20 mV	0.35% + 20 mV	0.25% + 15 mV	0.25% + 15 mV
Readback accuracy	0.35% + 20 mV	0.35% + 20 mV	0.25% + 10 mV	0.25% + 10 mV
Load and line regulation				
Voltage	0.01% + 2 mV	0.01% + 2 mV	0.01% + 2 mV	0.01% + 2 mV
Current	0.02% + 2 mA	0.02% + 2 mA	0.02% + 2 mA	0.02% + 2 mA
Ripple and noise (20 Hz to 20 MHz)	< 1 mVrms, 12 mVp-p	< 1 mVrms, 12 mVp-p	< 1 mVrms, 10 mVp-p (< 0.5 mVrms, 5 mVp-p typical)	< 1 mVrms, 10 mVp-p (< 0.5 mVrms, 5 mVp-p typical)
Meter resolution				
Voltage	10 mV	10 mV	10 mV	10 mV
Current	10 mA	10 mA	10 mA	10 mA
Transient response	< 50 μs	< 50 μs	< 50 μs	< 50 μs
Over-voltage and over-current protection	Yes	Yes	Yes	Yes